

NO DIMENSIONS TO BE SCALED FROM THIS DRAWING

| Rev | Date | Reference | Drawn / Chk'd |
|-----|------------|--------------------|---------------|
| P03 | 2020/09/04 | TOP SURVEY UPDATE. | AA AA |

SCHEDULE OF ACCOMMODATION - KEY

| | | |
|---|------------------|-----------------------|
|  | Site Area | 0.134ha (0.331 acres) |
| | Ground Floor GIA | 703 sq m |

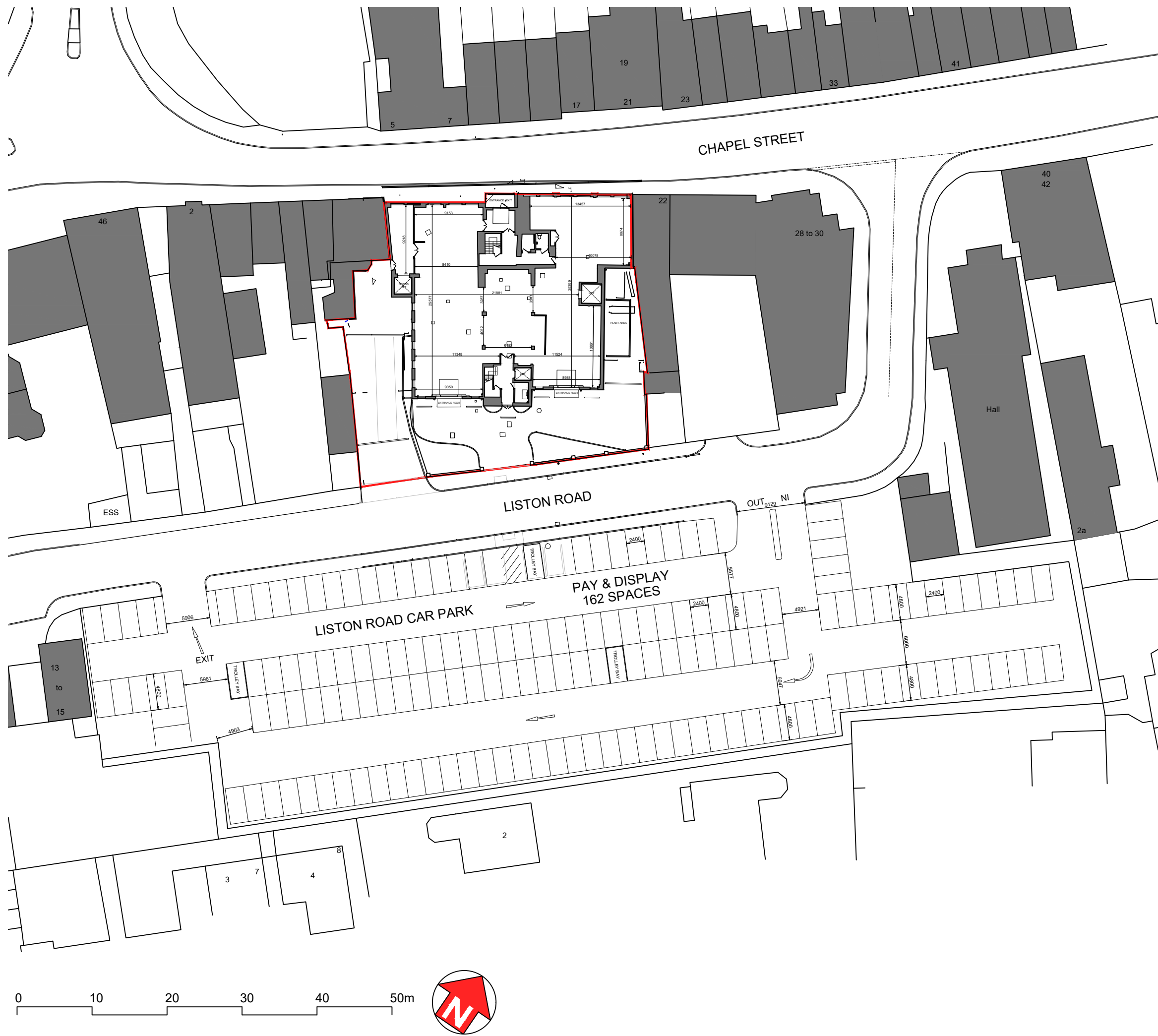

Client

Lidl Great Britain Ltd

Project

Lidl
14-20 Chapel Street, Marlow

Title

Site Plan as Existing

Drawing Ref. Revision

5080-0100 P03

| Scale - unless otherwise stated | Status | Issued For |
|---------------------------------|--------|-------------|
| 1:500 @ A3 | S0 | Preliminary |



KLH architects
 The Old Steelyard, Poplar Lane
 Sproughton, Ipswich, IP8 3HL
 t.01473 689532
 klh@klharchitects.com
 www.klharchitects.com